

Date Installed: 1-5-10  
 Installed by: Dotson Co. (Troy)  
 Inspected by: Rex Moll

Res # 890  
 N. Harmony Dr.

Indiana Ave.

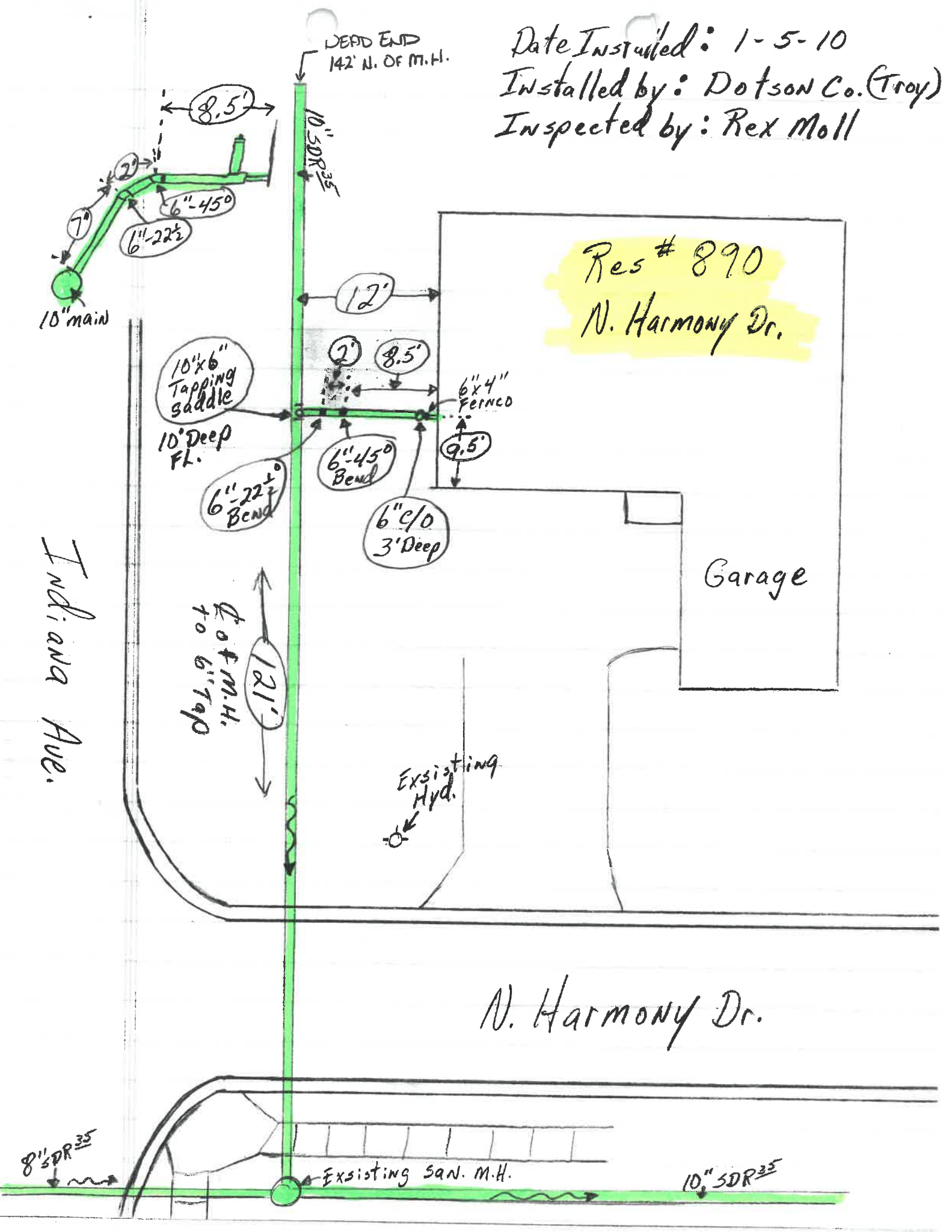

Date Installed: 1-5-10  
 Installed by: Dotson Co. (Troy)  
 Inspected by: Rex Moll

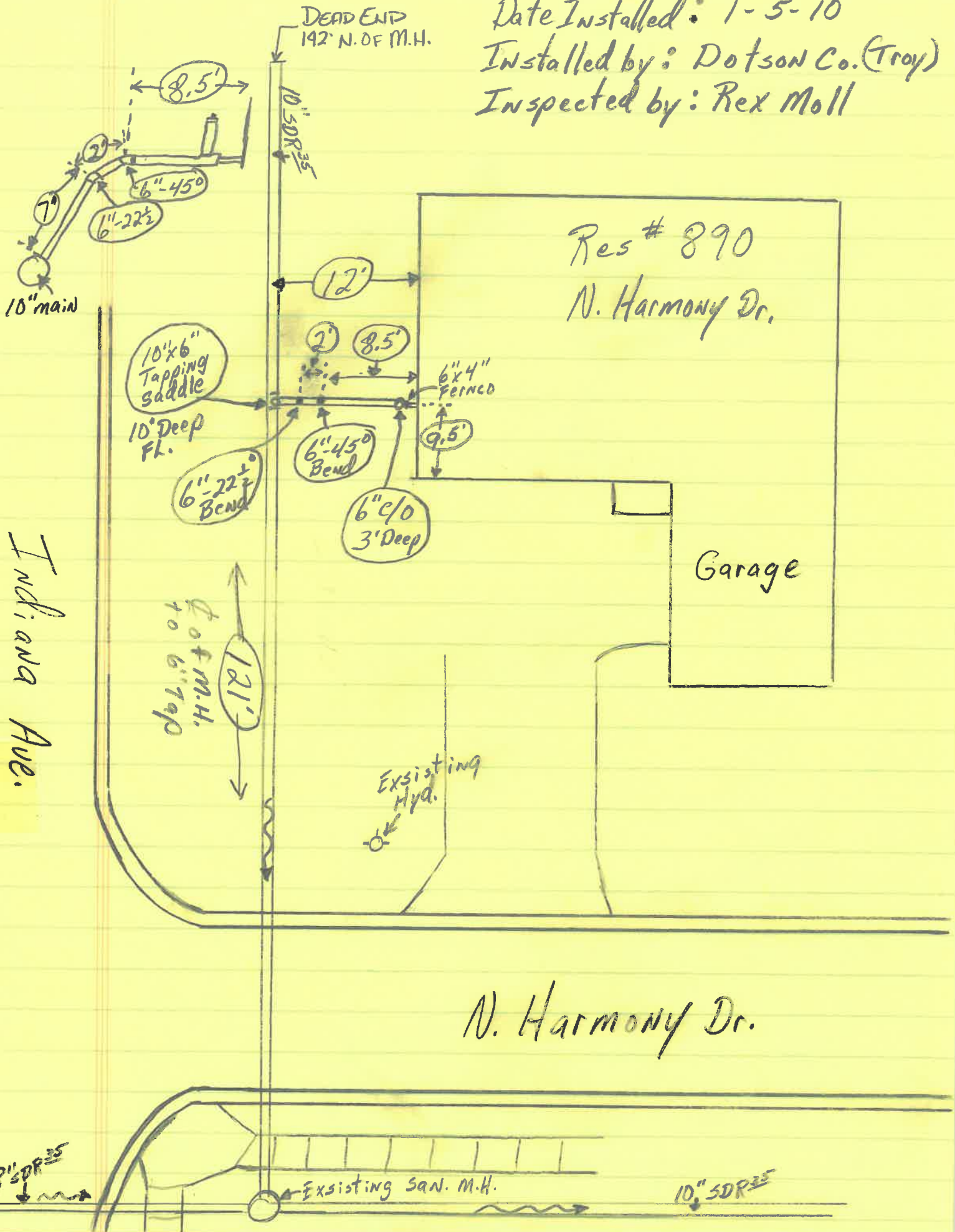

DEAD END  
192' N. OF M.H.

10" SDR<sup>35</sup>

10'x6" Tapping saddle  
10' Deep FK.

Res # 890  
N. Harmony Dr.

Garage

Indiana Ave.

121'  
to M.H.  
to 6" Tap

Existing Hyd.

N. Harmony Dr.

8" SDR<sup>35</sup>

Existing San. M.H.

10" SDR<sup>35</sup>